

VP-30-FA3 ELITE VP-20 VP-40 15 12 FA3 Hydraulic oil vane pump

SKU: 582488974287

Price: \$5.71

Categories: Hydraulics

Tags: ELITE

Product Link:

<https://www.electspares.com/product/vp-30-fa3-elite-vp-20-vp-40-15-12-fa3-hydraulic-oil-vane-pump/>

Product Description

Hydraulic oil pump VP-30-FA3 Taiwan ELITE vane pump VP-20 VP-40 15 12 FA3

Simple structure

Powerful

high speed

low noise

Low calorific value

Strong performance

efficient

long life

Direction of rotation: clockwise (viewed from shaft end) as the standard, only the. Confirm the direction of rotation of the instant starting motor to check. Hydraulic oil: 7.0Mpa, 40 °C viscosity 20-50cst (ISO VG32) of the hydraulic oil.

Oil pressure: vent pipe must be inserted directly into the oil tank under the surface, and the resulting back pressure piping, please maintain below 0.3kgf/cm. Working temperature: the temperature is 15-60 °C continuous operation.

Axis with: pump and motor of the eccentric error is 0.05mm, the angle error is 1 °. Oil pressure oil inlet pressure: 0.3kgf/cm² to 0.3kgf/cm².

Volume adjustment adjustment capacity, the first relaxation adjusting nut, then rotate the adjustment bolt, turn right to reduce emissions, and increase left the adjustment is completed, please tighten the nut.

Pressure adjustment turn left (counterclockwise) pressure adjustment screw, so that the output pressure is reduced, turn right (clockwise) increased, adjust the end, please tighten the nut.

Operation of the new machine: the new machine unning. should be repeated staring motor in a stress roe state, to the exckusion of the pump and suction pipe in the air, to ensure the exclusion of air within the system, at no load conditions,continuous operation for 10 minutes.

VP-08-FA3

VP-12-FA3

VP-15-FA3

VP-20-FA3

VP-30-FA3

VP-40-FA3

VP15/VP20 small shaft 12.7

VP15/VP20 large shaft 15.87

VP15/VP20 spline 7 teeth

VP15/VP20 spline 9 teeth

VP30/VP40 spline 9 teeth

VP-15-15-FA3 double pump

VP-20-20-FA3 double pump

VP-30-30-FA3 double pump

VP-40-40-FA3 double pump

HVP-30-FA3

HVP-40-FA3

Seven-tooth spline sleeve

Nine-tooth spline sleeve

Please contact customer service for the motor matching the oil pump.

Additional Information

sort by color: VP-08-FA3, VP-12-FA3, VP-15-FA3, VP-20-FA3, VP-30-FA3, VP-40-FA3, VP15/VP20 small shaft 12.7, VP15/VP20 large shaft 15.87, VP15/VP20 spline 7 teeth, VP15/VP20 spline 9 teeth, VP30/VP40 spline 9 teeth, VP-15-15-FA3 double pump, VP-20-20-FA3 double pump, VP-30-30-FA3 double pump, VP-40-40-FA3 double pump, HVP-30-FA3, HVP-40-FA3, Seven-tooth spline sleeve, Nine-tooth spline sleeve, Please contact customer service for the motor matching the oil pump.

Product Images



结构简单

动力大

速度快

噪音小

发热量小

性能强

效率高

寿命长

型式 Model	吐出能力 Delivery capacity(1800rpm)	壓力調整範圍 Pressure adj. range	額定速度 Rated speed	
			最高 Max.	最低 Min.
VP-08	8 L/min	3 ~ 70bar	1800 rpm	800 rpm
VP-12	12 L/min	3 ~ 70bar		
VP-15	15 L/min	3 ~ 70bar		
VP-20	20 L/min	3 ~ 70bar		

VP - ※ - F A ※ ※

连接方式:

DH:9齿花键, XH: 7齿花键,
D: 轴径15.875mm, X:轴径12.7mm,
B:扁轴;

压力范围 Pressure range

1:3-35bar, 2: 30-55bar, 3:50-70bar

安装方式 Mounting style

F: Flange mounting (法兰式)

吐出能力 Delivery capacity at At 1800 rpm
8L/min、12L/min、15L/min、20L/min

系列号码 Serial no.

尺寸圖/DIMENSIONS: VP-08、12、15、20

壓力調整螺栓
PRESSURE ADJUSTING BOLT○ 提升壓力
○ 降低壓力

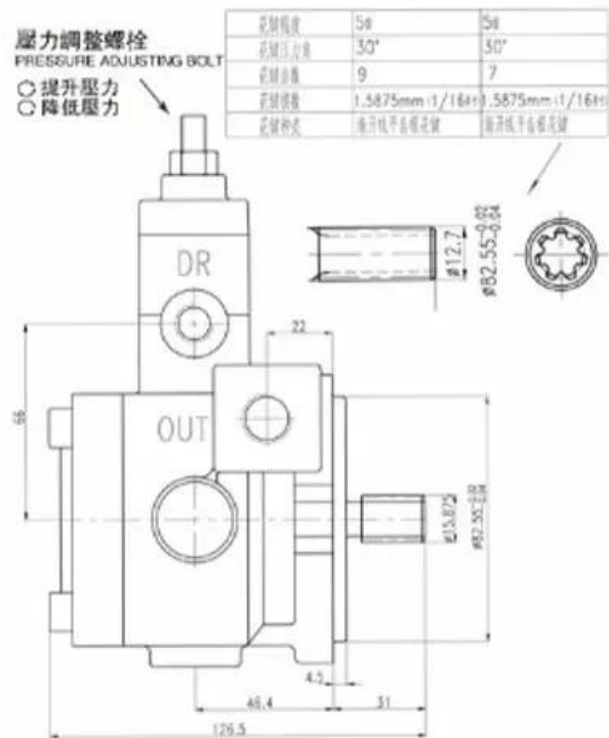
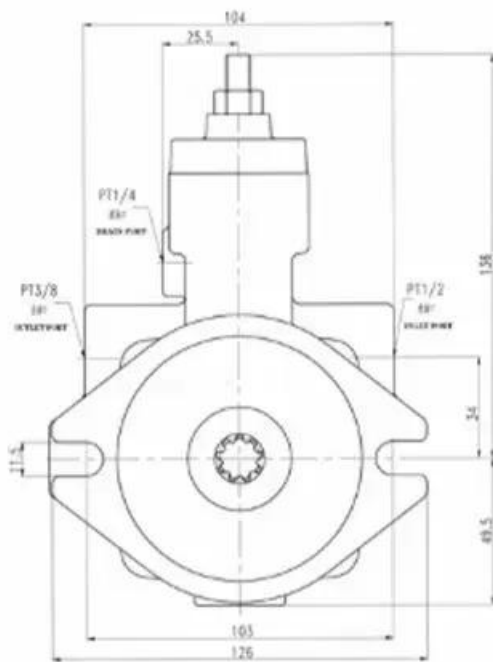
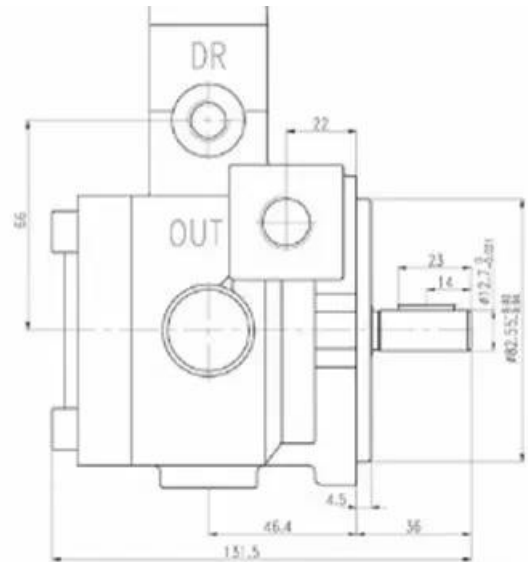
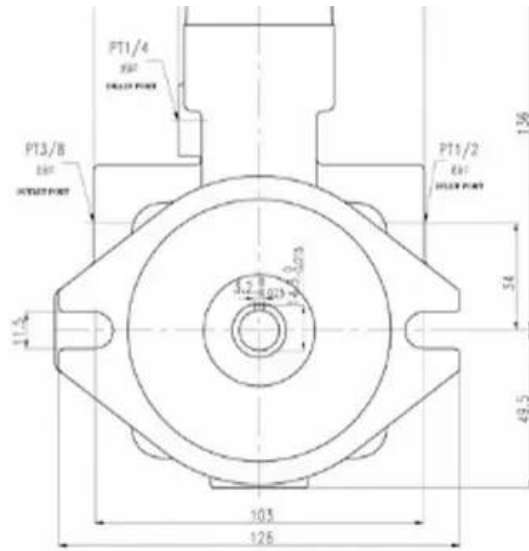

全新叶片泵

加粗电机 动力更足 稳定性更好

Scan for product details:

